

REV	ECN	REVISION RECORD	DATE	DR	CK
A	89XX	INITIAL RELEASE	04/25/14	PF	BR

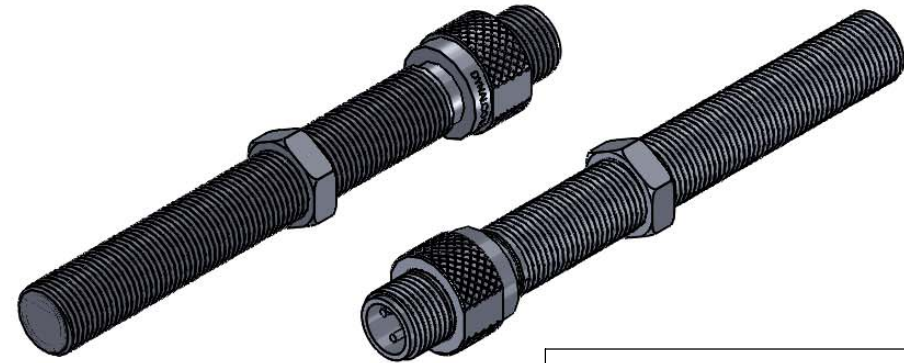
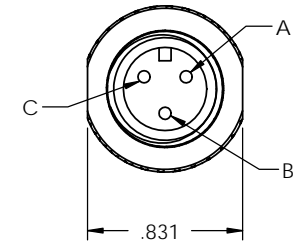
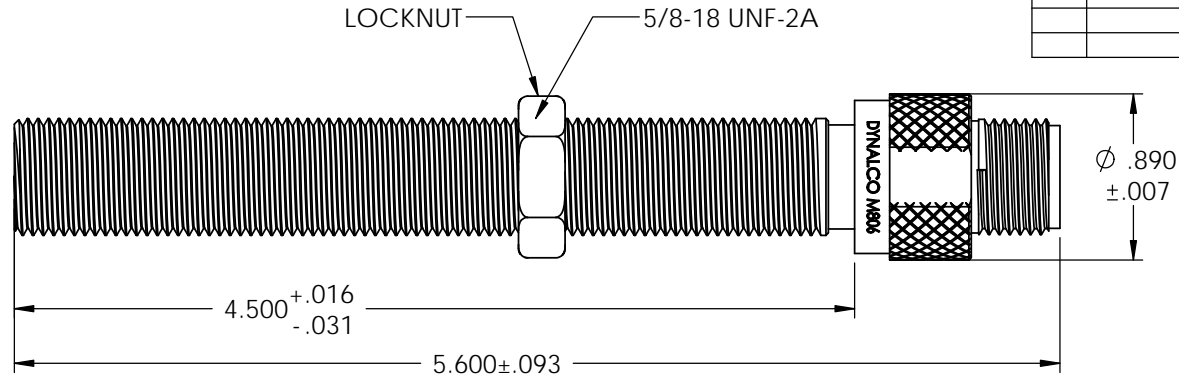

SPECIFICATIONS:

- POWER SUPPLY: 8 TO 32 VDC.
- SUPPLY CURRENT: 30 mA MAXIMUM
- OPERATING TEMPERATURE: -30 F TO +250 F (-35C to 125C)
- SENSED FREQUENCY: 0 TO 20 KHZ
- OUTPUT VOLTAGE: SQUARE WAVE.
- LOGIC 0: WHEN NO MAGNET PRESENT
* < 0.4 VDC AT < 50 mA SINK CURRENT.
- LOGIC 1: WHEN MAGNET ACTIVATES SENSOR
* 4.7 K Ω PULL UP TO Vin
 $V_{out} = V_{in} \times R_{load} / (R_{load} + 4.7K\Omega)$
- INSULATION RESISTANCE: 100 MEGA ohm MIN. AT 50 VDC (COMMON TO HOUSING)
- HOUSING: 303 STAINLESS STEEL, BLIND END
- OPERATING AIR GAP: 0.120 TYPICAL WITH NORTH POLE FACING TARGET MAGNET.

MOD-TRONIC

www.mod-tronic.com | sales@mod-tronic.com | 1-800-794-5883

ELECTRICAL CONNECTIONS

PIN A	OUTPUT
PIN B	POWER SUPPLY
PIN C	COMMON

UNLESS OTHERWISE SPECIFIED		THIRD ANGLE PROJECTION	
DIMENSIONS ARE IN INCHES DIMENSIONAL TOLERANCES: FRACTIONAL $\pm 1/64$ ANGULAR: $\pm 1/2^\circ$ XX ± 0.010 XXX ± 0.005		DYNALCO	
DATE: 03/03/14	MODEL: M806	DRAWN: PF	
MATERIAL:	PATH: N:\PROD\PICKUPS\M806	APPROVED: HM	
FINISH:	TITLE: PICKUP, HALL EFFECT, MODEL M806		
	SIZE: A	DWG. NO. 800-0806	REV: A
DO NOT SCALE DRAWING	SCALE: 1:1	WEIGHT:	SHEET: 1 OF 1